



Light makes the difference

HVP Lighting nv - Waregemstraat 200 - 8540 Deerlijk - T 056 72 97 61 - F 056 72 61 53 - info@hvplighting.com - www.hvplighting.com

Wist je dat ...

Wij reeds 3 jaar verdeler zijn van



Vraag een bezoek van onze vertegenwoordiger
voor gepersonaliseerde voorwaarden 056/72 97 61



Light makes the difference

HVP Lighting nv - Waregemstraat 200 - 8540 Deerlijk - T 056 72 97 61 - F 056 72 61 53 - info@hvplighting.com - www.hvplighting.com

EMERGENCY



EVOLUX

MULTIEVO-AT

<ul style="list-style-type: none"> • Non-maintained (NM) 	<ul style="list-style-type: none"> • Non-maintained (NM), Maintained (M) • Autotest
<ul style="list-style-type: none"> • Conforming to the requirement of EN 60598-2-22 • Design: Anodized AL base - PC impact resistant diffuser 	

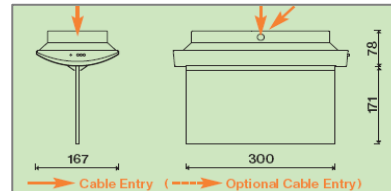

The recessed version mounting hole size: 319 x 123 mm

Standard accessoires:

- Special mirror effect reflector
- Emergency factor up to 50%=lower number of of the lighting fixtures
- LEDs indicating both presence of power supply and signaling failures
- TEST button

Options:

- Adhesive labels or non-adhesive labels together with aluminium frame
- Wall or ceiling brackets
- Protective steel cage

Optional Pictograms

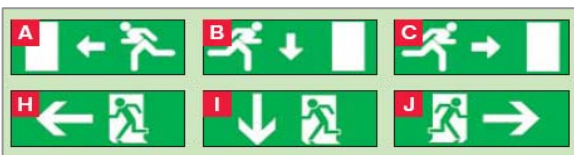

- Foil based pictogram + AL cover frame (click system)
- Viewing Distance 24m

Optional Labels

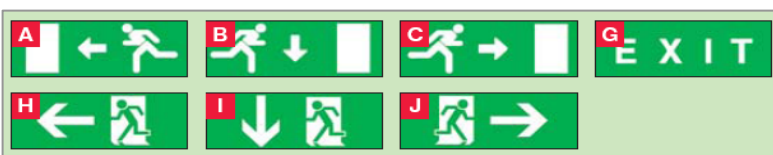

- Seld-adhesive pictogram
- Viewing Distance 34m



Light makes the difference

HVP Lighting nv - Waregemstraat 200 - 8540 Deerlijk - T 056 72 97 61 - F 056 72 61 53 - info@hvplighting.com - www.hvplighting.com

EMERGENCY

Surface version



Recessed version



EVOLUX

MULTIEVO-AT

<ul style="list-style-type: none"> • Non-maintained (NM) 	<ul style="list-style-type: none"> • Non-maintained (NM), Maintained (M) • Autotest
<ul style="list-style-type: none"> • Conforming to the requirement of EN 60598-2-22 • Design: Anodized AL base - PC impact resistant diffuser 	

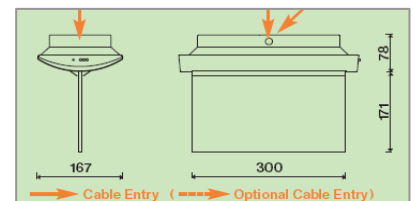

The recessed version mounting hole size: 319 x 123 mm

Standard accessoires:

- Special mirror effect reflector
- Emergency factor up to 50%=lower number of of the lighting fixtures
- LEDs indicating both presence of power supply and signaling failures
- TEST button

Options:

- Suspended plexi with pictogram (see picture)
- AL cover frame for suspended plexi with pictogram (see picture)
- Wall or ceiling brackets
- Protective steel cage

Optional Plexi

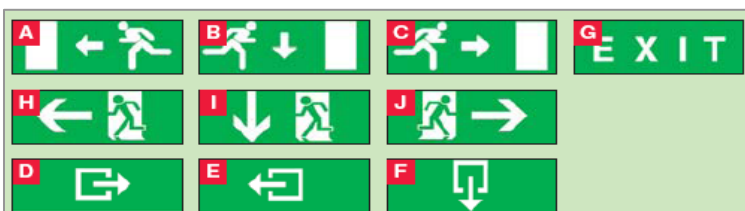

- Optional Doublesided Plexi
- Viewing Distance 27m



Light makes the difference

HVP Lighting nv - Waregemstraat 200 - 8540 Deerlijk - T 056 72 97 61 - F 056 72 61 53 - info@hvplighting.com - www.hvplighting.com

EMERGENCY



VISION-FLAT

MULTIVISION-FLAT-AT

- | | |
|--|---|
| <ul style="list-style-type: none"> • Non-maintained (NM) | <ul style="list-style-type: none"> • Non-maintained (NM), Maintained (M) • Autotest |
| <ul style="list-style-type: none"> • Conforming to the requirement of EN 60598-2-22 • Design: Metal body with PE powder coat finish RAL9003, Diffuser made of PMMA | |

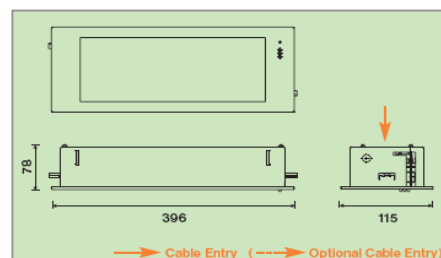

The recessed mounting hole size: 365 x 105 mm

Standard accessoires:

- LEDs indicating both presence of power supply and signaling failures
- TEST button

Options:

- Chromium surface treatment
- PRISMATIC diffuser



FLATLUX

MULTIFLAT-AT

- | | |
|--|---|
| <ul style="list-style-type: none"> • Non-maintained (NM) | <ul style="list-style-type: none"> • Non-maintained (NM), Maintained (M) • Autotest |
| <ul style="list-style-type: none"> • Conforming to the requirement of EN 60598-2-22 • Design: Metal body with PE powder coat finish RAL9003, Diffuser made of PMMA | |

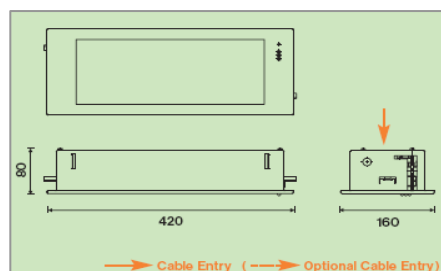

The recessed mounting hole size: 395 x 130mm

Standard accessoires:

- LEDs indicating both presence of power supply and signaling failures
- TEST button

Options:

- Another powder painting colour in RAL9006



Light makes the difference

HVP Lighting nv - Waregemstraat 200 - 8540 Deerlijk - T 056 72 97 61 - F 056 72 61 53 - info@hvplighting.com - www.hvplighting.com

EMERGENCY



STAIRLUX

- Non-maintained (NM)
- Equipped with 11W fluorescent tube
- Conforming to the requirement of EN 60598-2-22
- Design: Metal base with PE powder painting RAL9003, Opal-PMMA-diffuser (11W) or PRISMATIC one (LED version)



Standard accessoires:

- LEDs indicating presence of power supply
- TEST button

Options:

- Alternative size according to customer requirement
- Alternative colour in RAL
- Self-adhesive label with pictogram

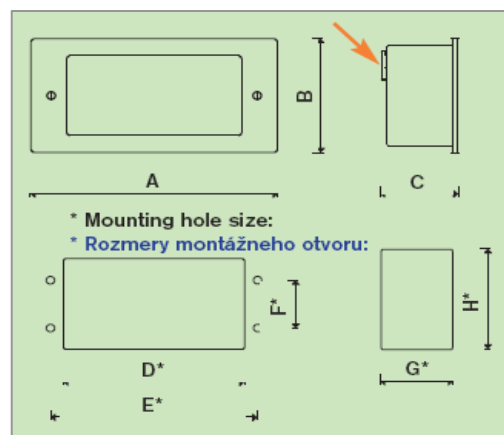

Dimensions (AxBxCxDxExFxGxH):

- Size X1:
320x130x90x285x300x50x95x105 mm



Light makes the difference

HVP Lighting nv - Waregemstraat 200 - 8540 Deerlijk - T 056 72 97 61 - F 056 72 61 53 - info@hvplighting.com - www.hvplighting.com

EMERGENCY IP65



BASET

- Non-maintained (NM)

MULTIBASET

- Non-maintained (NM), Maintained (M)

- Conforming to the requirement of EN 60598-2-22
- Design: PC impact resistant body

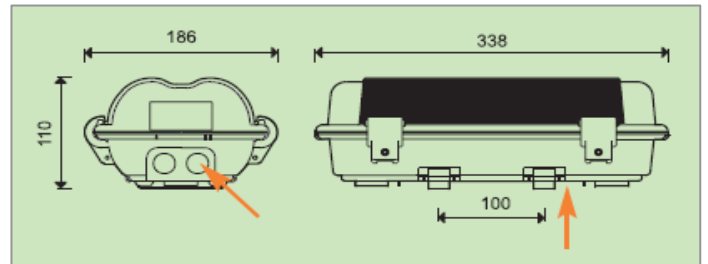

Standard accessoires:

- 4pcs of self-adhesive pictograms (standard set A,B,C,G)
- 2pcs of steel „click mounting“ clips
- 2pcs of hooks for suspended instalation
- LEDs indicating presence of power supply
- TEST button

Options:

- Self-adhesive labels (set H,I,J)
- Wall or ceiling mounting brackets
- Protective steel cage



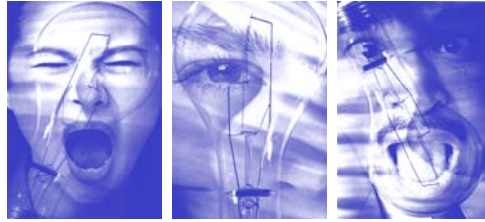

Light makes the difference

HVP Lighting nv - Waregemstraat 200 - 8540 Deerlijk - T 056 72 97 61 - F 056 72 61 53 - info@hvplighting.com - www.hvplighting.com

EMERGENCY IP65



PERUN

MULTIPERUN

- Non-maintained (NM)

- Non-maintained (NM), Maintained (M)

- Conforming to the requirement of EN 60598-2-22
- Design: PC impact resistant body

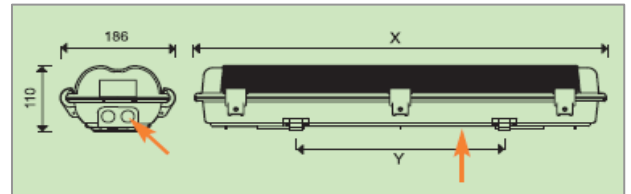

Standard accessoires:

- 4pcs of self-adhesive pictograms (standard set A,B,C,G)
- 2pcs of steel „click mounting“ clips
- 2pcs of hooks for suspended instalation
- LEDs indicating presence of power supply
- TEST button

Options:

- Self-adhesive labels (set H,I,J)
- Wall or ceiling mountiung brackets
- Protective steel cage

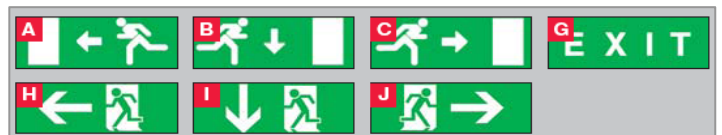

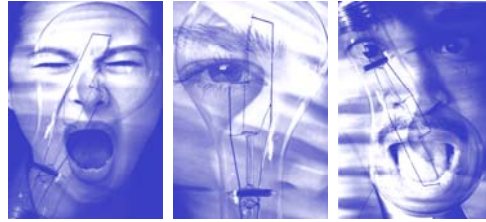

Light makes the difference

HVP Lighting nv - Waregemstraat 200 - 8540 Deerlijk - T 056 72 97 61 - F 056 72 61 53 - info@hvplighting.com - www.hvplighting.com

EMERGENCY IP65



SERTRO

MULTISETRO-AT

- Non-maintained (NM)

- Non-maintained (NM), Maintained (M)
- Autotest

- Conforming to the requirement of EN 60598-2-22
- Design: Body made of PC

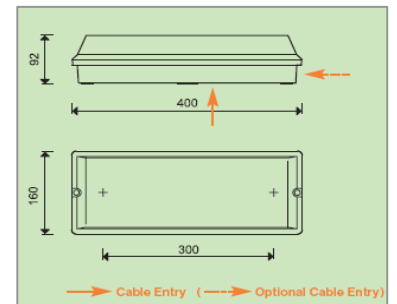

Standard accessoires:

- 4pcs of self-adhesive pictograms (standard set A,B,C,G)
- LEDs indicating presence of power supply
- TEST button

Options:

- Self-adhesive labels (set H,I,J)
- Wall or ceiling mounting brackets
- Protective steel cage
- Side cable entry



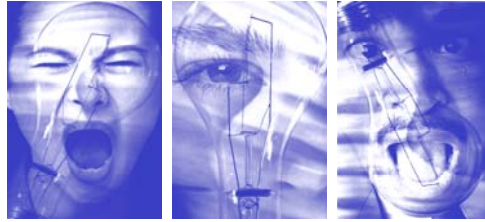

Light makes the difference

HVP Lighting nv - Waregemstraat 200 - 8540 Deerlijk - T 056 72 97 61 - F 056 72 61 53 - info@hvplighting.com - www.hvplighting.com

EMERGENCY IP65



NOVALUX

- Non-maintained (NM)

MULTINOVA-AT

- Non-maintained (NM), Maintained (M)
- Autotest

- Conforming to the requirement of EN 60598-2-22
- Design: PC impact resistant body

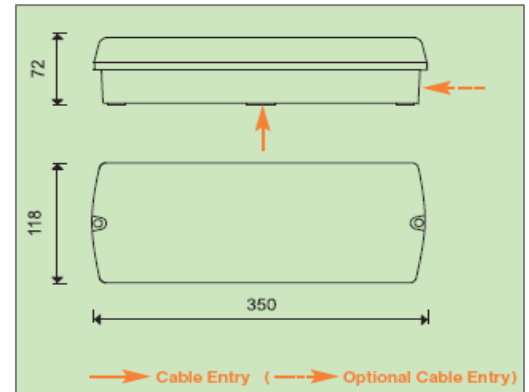

Standard accessoires:

- 4pcs of self-adhesive labels (set A,B,C,G)
- 1pc of cable entry
- Emergency factor up to 50%=lower number of of the lighting fixtures
- signaling LED and TEST button

Options:

- Self-adhesive labels (set H,I,J)
- Side cable entry (2pcs)
- Suspended plexi with the pictogram
- Wall or ceiling brackets



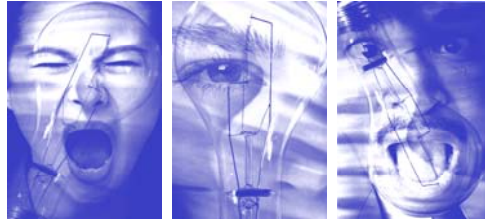

Light makes the difference

HVP Lighting nv - Waregemstraat 200 - 8540 Deerlijk - T 056 72 97 61 - F 056 72 61 53 - info@hvplighting.com - www.hvplighting.com

EMERGENCY LED



EVOLUX

MULTIEVO-LED-AT

<ul style="list-style-type: none"> • Non-maintained (NM) 	<ul style="list-style-type: none"> • Non-maintained (NM), Maintained (M) • Autotest
<ul style="list-style-type: none"> • Conforming to the requirement of EN 60598-2-22 • Design: Anodized AL base - PC impact resistant diffuser 	

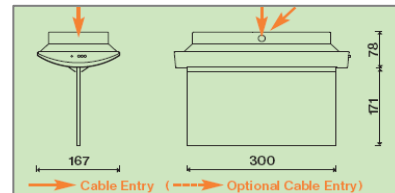

The recessed version mounting hole size: 319 x 123 mm

Standard accessoires:

- Special mirror effect reflector
- Emergency factor up to 50%=lower number of of the lighting fixtures
- LEDs indicating both presence of power supply and signaling failures
- TEST button

Options:

- Adhesive labels or non-adhesive labels together with aluminium frame
- Wall or ceiling brackets
- Protective steel cage

Optional Pictograms

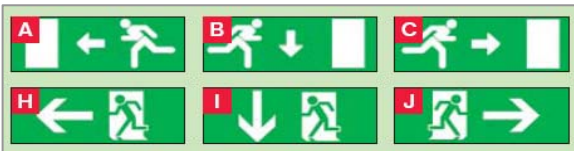

- Foil based pictogram + AL cover frame (click system)
- Viewing Distance 24m

Optional Labels

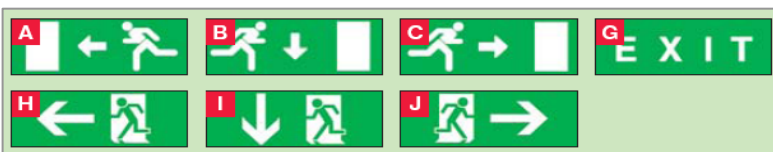

- Seld-adhesive pictogram
- Viewing Distance 34m

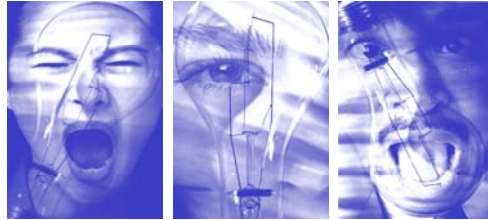

Light makes the difference

HVP Lighting nv - Waregemstraat 200 - 8540 Deerlijk - T 056 72 97 61 - F 056 72 61 53 - info@hvplighting.com - www.hvplighting.com

EMERGENCY LED

Surface version



MULTILED-SPOT

MULTILED-SPOT-AT

<ul style="list-style-type: none"> • Non-maintained (NM) 	<ul style="list-style-type: none"> • Non-maintained (NM), Maintained (M) • Autotest
<ul style="list-style-type: none"> • Conforming to the requirement of EN 60598-2-22 • Design: Anodized AL base - PC impact resistant diffuser 	

Recessed version

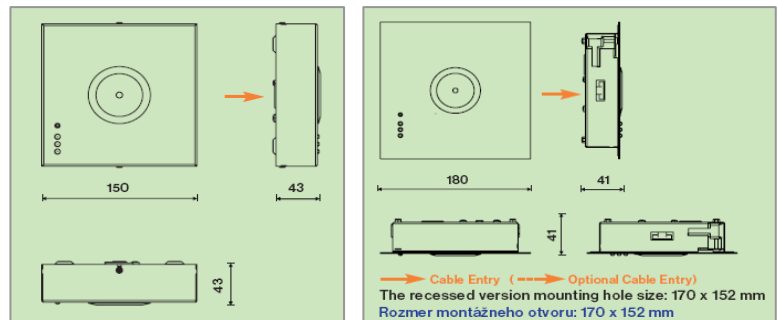

Standard accessoires:

- 1W powerful LED (by LUMILEDS-LUXEON)
- Special shaped AL reflector
- LEDs indicating both presence of power supply and signaling failures
- TEST button

Options:

- ATX electronic module upgrade for ELMAX Central-Test
- Body in RAL9003 (white) powder coat finish



Light makes the difference

HVP Lighting nv - Waregemstraat 200 - 8540 Deerlijk - T 056 72 97 61 - F 056 72 61 53 - info@hvplighting.com - www.hvplighting.com

EMERGENCY LED

Surface version



Recessed version



LEDLUX

MULTILED-AT

- | | |
|--|---|
| <ul style="list-style-type: none"> • Non-maintained (NM) | <ul style="list-style-type: none"> • Non-maintained (NM), Maintained (M) • Autotest |
| <ul style="list-style-type: none"> • Conforming to the requirement of EN 60598-2-22 • Design: Metal body with PE powder coat finish RAL9003, | |



The recessed version mounting hole : 336 x 50 mm

Standard accessoires:

- white colour LEDs
- Special layered plexi diffuser for perfect illumination of pictogram
- LEDs indicating both presence of power supply and signaling failures
- TEST button

Options:

- Body in RAL9003 (white) powder coat finish
- Wall / ceiling mounting brackets

Separate Double-Sided Plexi





Light makes the difference

HVP Lighting nv - Waregemstraat 200 - 8540 Deerlijk - T 056 72 97 61 - F 056 72 61 53 - info@hvplighting.com - www.hvplighting.com

EMERGENCY LED

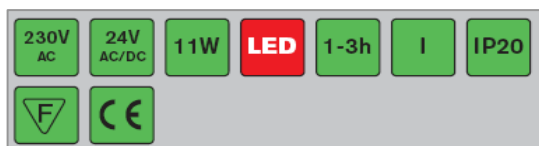

Standard accessoires:

- LEDs indicating presence of power supply
- TEST button

Options:

- Alternative size according to customer requirement
- Alternative colour in RAL
- Self-adhesive label with pictogram

MULTISTAIR-LED

- Non-maintained (NM), Maintained (M)
- Conforming to the requirement of EN 60598-2-22
- Design: Metal base with PE powder painting RAL9003, Diffuser PRISMATIC

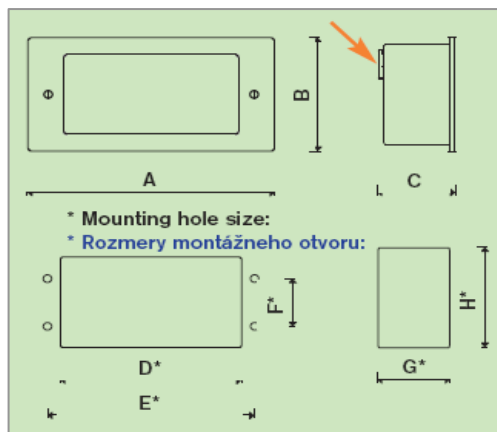

Dimensions (AxBxCxDxExFxGxH):

- Size X1:
320x130x90x285x300x50x95x105 mm

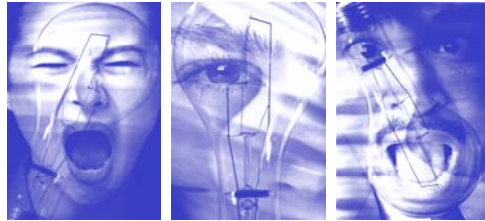

Light makes the difference

HVP Lighting nv - Waregemstraat 200 - 8540 Deerlijk - T 056 72 97 61 - F 056 72 61 53 - info@hvplighting.com - www.hvplighting.com

EMERGENCY LED



MULTISETRO-LED-AT

- Non-maintained (NM), Maintained (M)
- Autotest
- NEW version equipped with long life-time 5x3W LEDs is available ensuring the light output 240lm with perfect light distribution
- Conforming to the requirement of EN 60598-2-22
- Design: Body made of PC

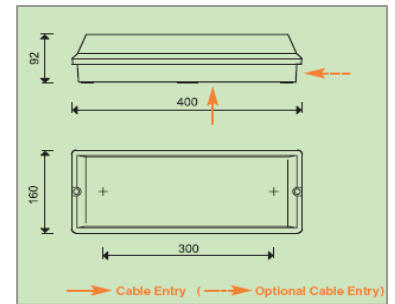

Standard accessoires:

- 4pcs of self-adhesive pictograms (standard set A,B,C,G)
- LEDs indicating presence of power supply
- TEST button

Options:

- Self-adhesive labels (set H,I,J)
- Wall or ceiling mounting brackets
- Protective steel cage
- Side cable entry





Light makes the difference

HVP Lighting nv - Waregemstraat 200 - 8540 Deerlijk - T 056 72 97 61 - F 056 72 61 53 - info@hvplighting.com - www.hvplighting.com

EMERGENCY IP66 - Explosion Proof



BASET-N-EEEx

MULTIBASET-N-EEEx

- | | |
|--|---|
| <ul style="list-style-type: none"> • Non-maintained (NM) • Explosion-proof all wall/ceiling mounting • Conforming to the requirement of EN 60598-2-22 • Design: PC impact resistant body | <ul style="list-style-type: none"> • Non-maintained (NM), Maintained (M) |
|--|---|

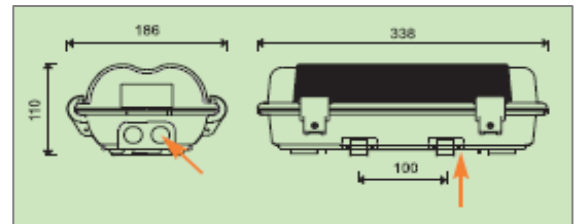
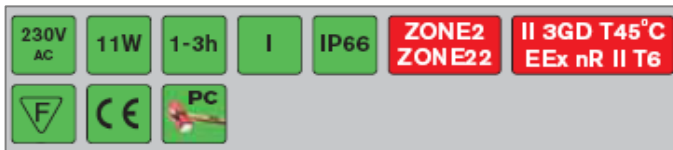

Standard accessoires:

- 2pcs of steel „click mounting“ clips
- 2pcs of hooks for suspended instalation
- LEDs indicating presence of power supply
- TEST button

Options:

- Wall or ceiling mountiung brackets
- Protective steel cage

Optional Labels

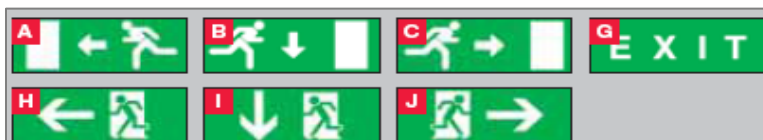

- Self-adhesive labels (set H,I,J or set A,B,C,G)



Light makes the difference

HVP Lighting nv - Waregemstraat 200 - 8540 Deerlijk - T 056 72 97 61 - F 056 72 61 53 - info@hvplighting.com - www.hvplighting.com

EMERGENCY IP66 - Explosion Proof



MULTIVIPET-N-EM EEx

- Non-maintained (NM), Maintained (M)
- Explosion-proof all wall/ceiling mounting
- Conforming to the requirement of EN 60598-2-22
- Design: PC impact resistant body

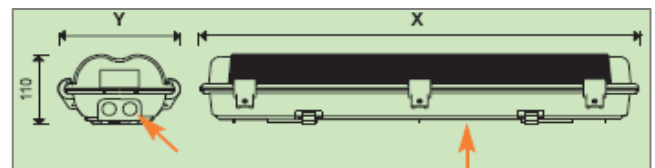

Standard accessoires:

- 2pcs of steel „click mounting“ clips
- 2pcs of hooks for suspended instalation
- LEDs indicating presence of power supply
- TEST button

Options:

- Self-adhesive labels (the type must be specified in the order)
- Wall or ceiling mounting brackets
- Protective steel cage